

P1H Miniature Filter/Regulator-Lubricator

— Compact design



Technical features

Fluid:
Compressed air

Maximum pressure:
10 bar (145 psi) Transparent bowl
17 bar (246 psi) Metal bowl

Pressure range:
0,3 ... 7 bar (4 ... 101 psi),
0,3 ... 3,5 bar (4 ... 50 psi),
0,1 ... 0,7 bar (1 ... 10 psi)

Filter element:
5 or 40 µm

Port size:
G1/8 or G1/4
Rc1/8 (Gauge)

Bowl:
31 ml

Flow:
Start point 0,24 dm³/s
see below

Drain:
Manual or automatic

Ambient/Media temperature:
Transparent bowl
-34 ... +50°C (-29 ... +122°F)
Metal bowl
-34 ... +65°C (-29 ... +149°F)
Air supply must be dry enough
to avoid ice formation at
temperatures below +2°C (+35°F).

Materials:
Body: Zinc alloy
Bonnet: Acetal (Regulator)
Knob: Acetal
Bowl: Plastic or Zinc alloy
Filter element: Sintered PP
Valve: Brass
Sight dome: PA
Seals: NBR

Technical data, standard model - relieving

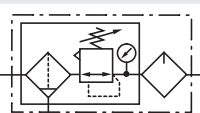
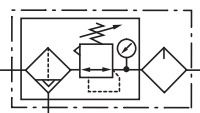
Symbol	Port size	Pressure range (bar)	Filter element (µm)	Flow *1) (dm³/s)	Drain	Bowl	Gauge	Weight (kg)	Model
	G1/8	0,3 ... 7	40	3	Manual	Plastic	Standard	0,35	P1H-100-M3QG
	G1/4	0,3 ... 7	40	3	Manual	Plastic	Standard	0,35	P1H-200-M3QG
	G1/8	0,3 ... 7	40	3	Automatic	Plastic	Standard	0,35	P1H-100-A3QG
	G1/4	0,3 ... 7	40	3	Automatic	Plastic	Standard	0,35	P1H-200-A3QG

*1) Approximate flow at 7 bar (101psi) inlet pressure, 6,3 bar (91 psi) set pressure and a droop of 1 bar (14 psi) from set.

Options selector

		P★H-★★★★-★★★★			
Integral Wall Bracket	Substitute			Threads	Substitute
Without	1			PTF	A
With	T			ISO G	G
Port Size	Substitute			Lubricator reservoir	Substitute
1/8"	1			Plastic with drain	A
1/4"	2			Plastic without drain	Q
Bowl/Pressure range/Gauge	Substitute			Metal with drain	M
Plastic/0,3 ... 7 bar/with	00			Element	Substitute
Plastic/0,3 ... 7 bar/without	01			5 µm	1
Plastic/0,3 ... 3,5 bar/without	04			40 µm	3
Plastic/0,3 ... 3,5 bar/with	05			Drain	Substitute
Metal/0,3 ... 7 bar/with	40			Automatic	A
Metal/0,3 ... 7 bar/without	41			Manual	M
Metal/0,3 ... 3,5 bar/without	44				
Metal/0,3 ... 3,5 bar/with	45				

Flow characteristics

Port size 1/4", 40 µm Filter element, pressure range 0,3 ... 7 bar

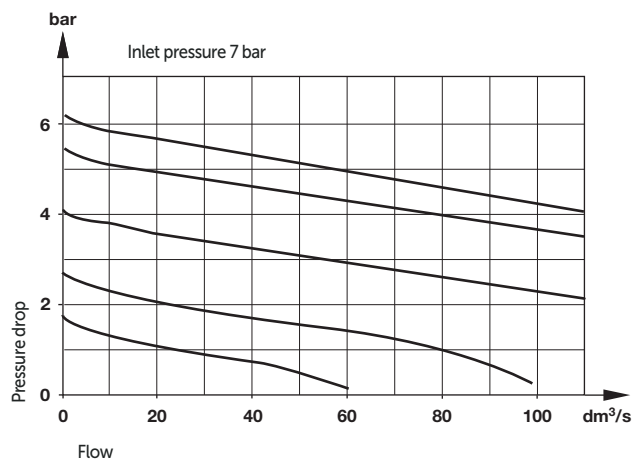
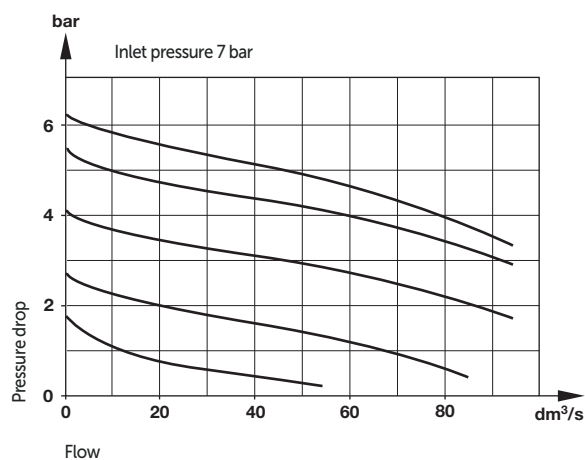

Accessories



Service kit



Wall mounting bracket and panel nut	Panel nut	Tamper resistant field modification	Wall mounting bracket	Tamper resistant seal wire for lubricator	Gauge Ø 40 mm
					
1 6 4	4	3	7		6
18-025-003 (with plastic nut)	2962-04 (Metal)	18-001-092	6700-30	2117-01	18-015-990 (0 ... 4 bar)
18-025-004 (with metal nut)	2962-89 (Plastic)				18-015-989 (0 ... 10 bar)

Dimensions

P1H-... PTH-...

Wall mounting bracket

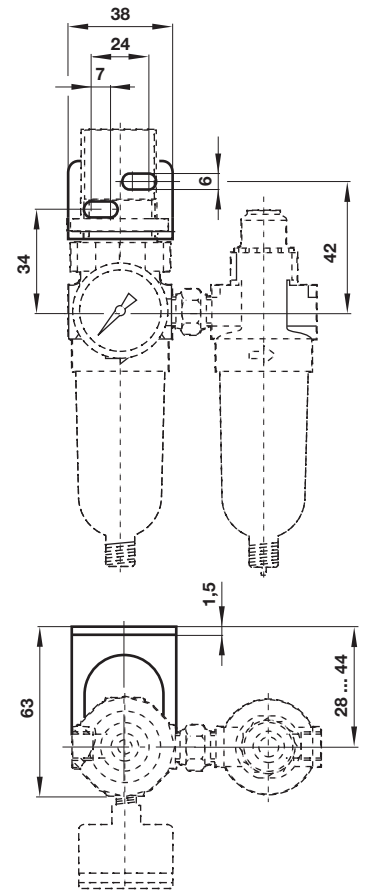
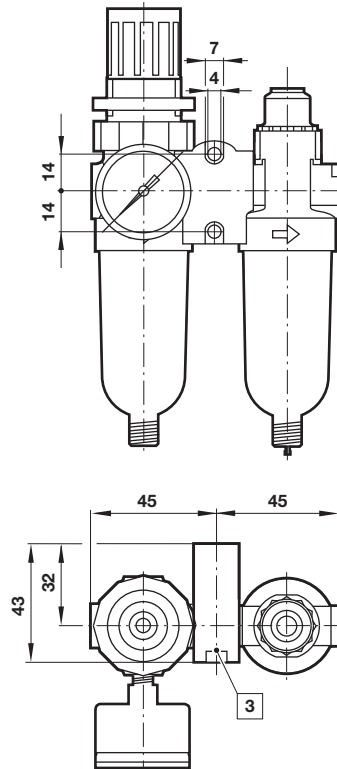
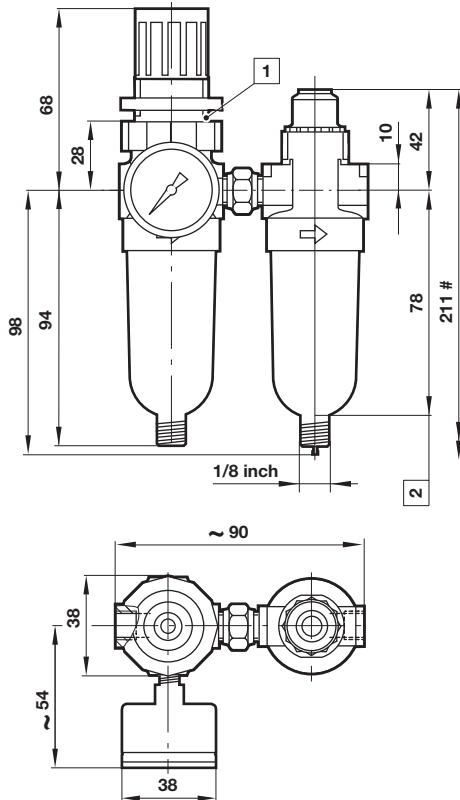

Minimum clearance required to remove bowl
 1 Ø31 mm for panel mounting

Warning

These products are intended for use in industrial compressed air systems only. Do not use these products where pressures and temperatures can exceed those listed under »Technical features/data«.

Before using these products with fluids other than those specified, for non-industrial applications, life-support systems or other applications not within published specifications, consult Norgren Ltd.

Through misuse, age, or malfunction, components used in fluid power systems can fail in various modes.

The system designer is warned to consider the failure modes of all component parts used in fluid power systems and to provide adequate safeguards to prevent personal injury or damage to equipment in the event of such failure.

System designers must provide a warning to end users in the system instructional manual if protection against a failure mode cannot be adequately provided.

System designers and end users are cautioned to review specific warnings found in instruction sheets packed and shipped with these products.